



# SUBMITTAL/TECHNICAL DATA SHEET

## DESCRIPTION

The First STC-Rated Access Panel with an STC 47 Rating. Meet Noise Containment and Sound Transmission Blocking Requirements for Walls with the US Patent-Pending STC Panel.

## SPECIFICATIONS

**INSTALLATION:** Walls only. Use sound-blocking sealant.

**CONSTRUCTION:** 16 gauge CRS 1" Wide Frame, and Door is 20 gauge CRS

**FINISH:** White powder coat paint.

**HARDWARE:** Heavy Duty, Continuous Hinge

**LATCH/LOCK:** Black, Non-locking Compression Paddle Latch, 2 for Heights Greater than 30". (F3)

**GASKETING:** Heavy Duty EPDM Rubber

**INSULATION:** Proprietary Sound-Blocking Assembly

**STC RATING:** 47 When Installed as Directed in STC-rated Wall.

**SIZES:** Minimum 12" x 12", Maximum 24" x 36"

**LABELING:** Intertek Warnock Hersey Listing

**PATENT PENDING:** US5171079



SKU: **STC**

**SOUND RATED ACCESS PANEL**

## DIMENSIONS AND APPEARANCE

>> CLICK TO VIEW ADDITIONAL DETAILS AND PRICING <<

### STANDARD SIZES:

MODEL & SIZE (A) W x H (Inches)	WALL OPENING DIMENSION (C)	APPROX. WEIGHT	LATCHES
STC-1212	12 3/8 x 12 3/8	14	1
STC-1414	14 3/8 x 14 3/8	18	1
STC-1616	16 3/8 x 16 3/8	23	1
STC-1818	18 3/8 x 18 3/8	29	1
STC-2030	20 3/8 x 30 3/8	53	2
STC-2222	22 3/8 x 22 3/8	40	1
STC-2230	22 3/8 x 30 3/8	53	2
STC-2236	22 3/8 x 36 3/8	55	2
STC-2424	24 3/8 x 24 3/8	46	1
STC-2430	24 3/8 x 30 3/8	54	2
STC-2436	24 3/8 x 36 3/8	60	2

Other Sizes up to 24" x 36" in 1/4" Increments Door Size Available



Optional Locking Black Latch F4



Standard Non Locking Black Latch F3



Optional Locking Chrome-plated Latch F6



Optional Non Locking Chrome-plated Latch F5



STC-2436F3G in Gray



Gasketing: Heavy Duty EPDM Rubber

For detailed specifications see submittal sheet

For a complete list of options visit [www.AccessDoorsAndPanels.com](http://www.AccessDoorsAndPanels.com)

## PROJECT DATA

Custom Sizes Available - Fast!

PROJECT NAME :	QTY	W	H	OPTIONS
ARCHITECT :				
DEALER :				
CONTRACTOR :				
LOCATION :	SPECIAL INSTRUCTIONS :			
DATE :	SUBMITTAL APPROVAL : (signature or stamp)			
TAGGING INSTRUCTIONS :				

Scan or Click



To view Pricing and Additional Product Info.

TELEPHONE:  
1-888-457-1275  
FAX:  
1-888-626-2907



PO BOX 66738 #76520,  
SAINT LOUIS, MO  
63166-6738  
USA



WEBSITE:  
[www.AccessDoorsAndPanels.com](http://www.AccessDoorsAndPanels.com)  
E-MAIL:  
[info@AccessDoorsAndPanels.com](mailto:info@AccessDoorsAndPanels.com)



# SUBMITTAL

TELEPHONE:  
1-888-457-1275  
FAX:  
1-888-626-2907

PO BOX 66738 #76520,  
SAINT LOUIS, MO  
63166-6738  
USA

WEBSITE:  
www.AccessDoorsAndPanels.com  
E-MAIL:  
info@AccessDoorsAndPanels.com

# SP

# FLAT FRAME 10 GAUGE STEEL SECURITY PANEL WITH DETENTION DEADLOCK

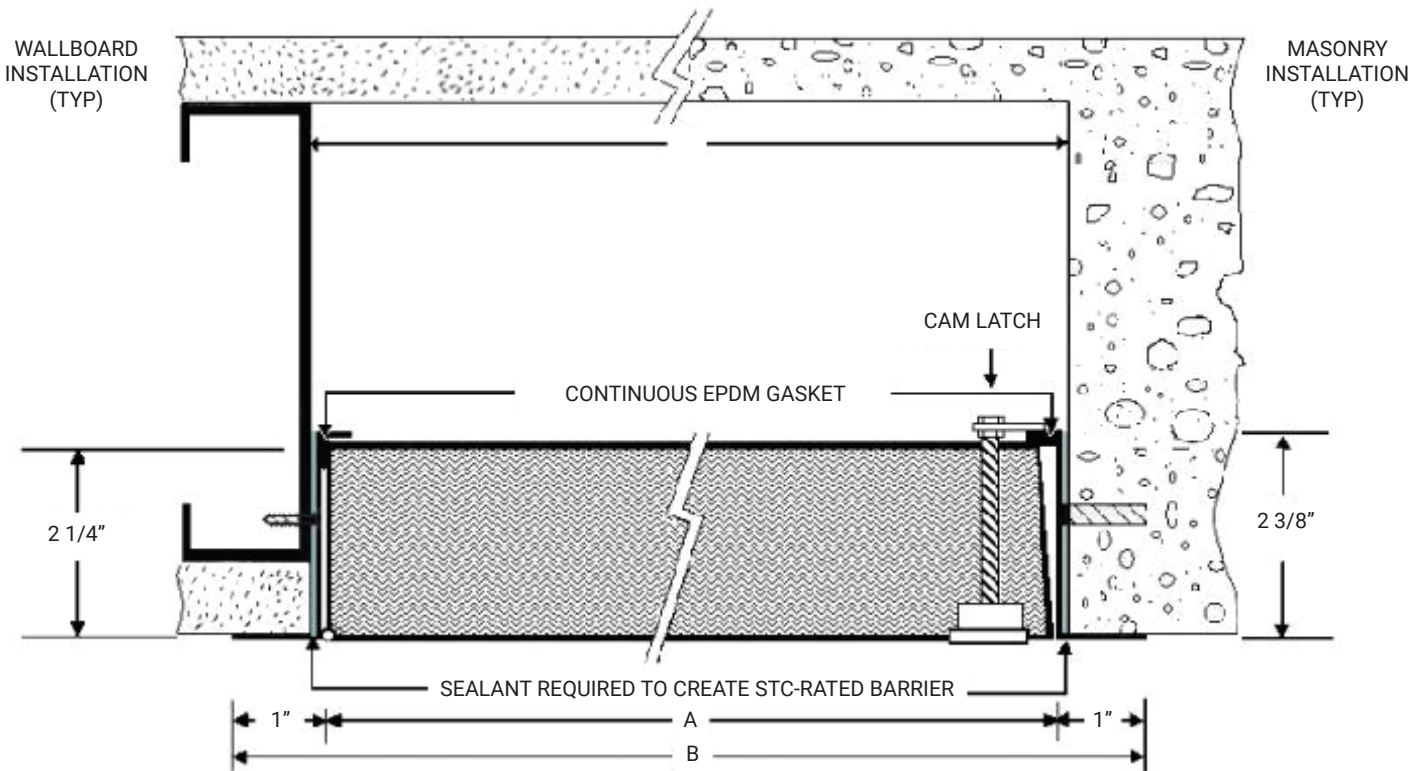

THE STC ACCESS PANEL CAN BE INSTALLED IN A WIDE RANGE OF STC-RATED WALLS  
THE DRAWING ABOVE IS AN EXAMPLE ONLY

Standard Color is White, Optional Colors at Additional Cost



### OPTIONAL FEATURES AT ADDITIONAL COST:

- Locking Flush Black Paddle Latch (F4) - See Page 1
- Locking Paddle Latch Chrome-plated (F6) - See Page 1
- Non Locking Paddle Latch Chrome-plated (F5) - See Page 1
- Stainless Steel - 16 ga Frame, 20 ga Door
- Galvanneal Steel - 16 ga Frame, 20 ga Door
- Other Powder Coat Paint Colors. Indicate Color Code Here:

TESTED IN ACCORDANCE WITH:  
ASTM E90-09  
Sound Transmission Loss of Building Partitions  
CLASSIFIED IN ACCORDANCE WITH:  
ASTM E413-10 Classification for Rating Sound Insulation of Partitions or Floors  
ASTM E1332-10a Standard Classification for Rating Outdoor-Indoor Sound Attenuation

